

AL YARMOUK MED-LAB FURNITURE



اليرموك للأثاث الطبي والمعملي

The Main content



Photos

Raw materials
coating process

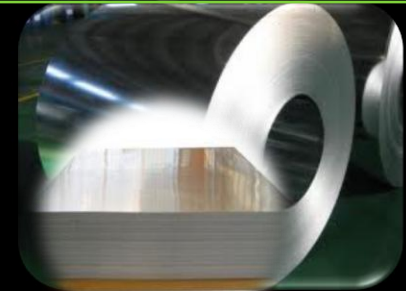

Construction system of base cabinets

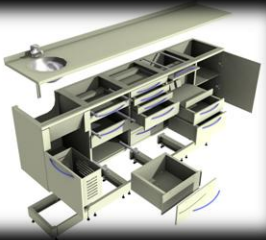

Wall cabinets

Hinge system

Drawers runner System

Quality – Made in KSA

Contact us



AL-YARMOUK® pay attention to the details

Samples of pictures

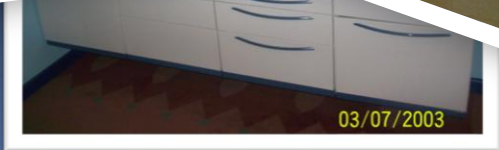

03/07/2003

Yarmouk Flexible Lab System



**SLIDING &
SUSPENDED CABINETS**

Blood bank lab in VACSIRA





Chemistry lab

NAJRAN faculty



PREPARATION ROOM



Future university Cairo



Private lab

Microbiology lab in



A photograph of a simulation lab, viewed through a circular frame. The room contains several dental workstations. Each workstation consists of a white desk with a blue cabinet and drawers. On top of the desks are dental chairs, which are pink and appear to be simulation heads. Blue office chairs are positioned in front of the desks. The floor is made of light-colored, square tiles. The background shows a window with blinds and a wall with a light switch.

Simulation lab

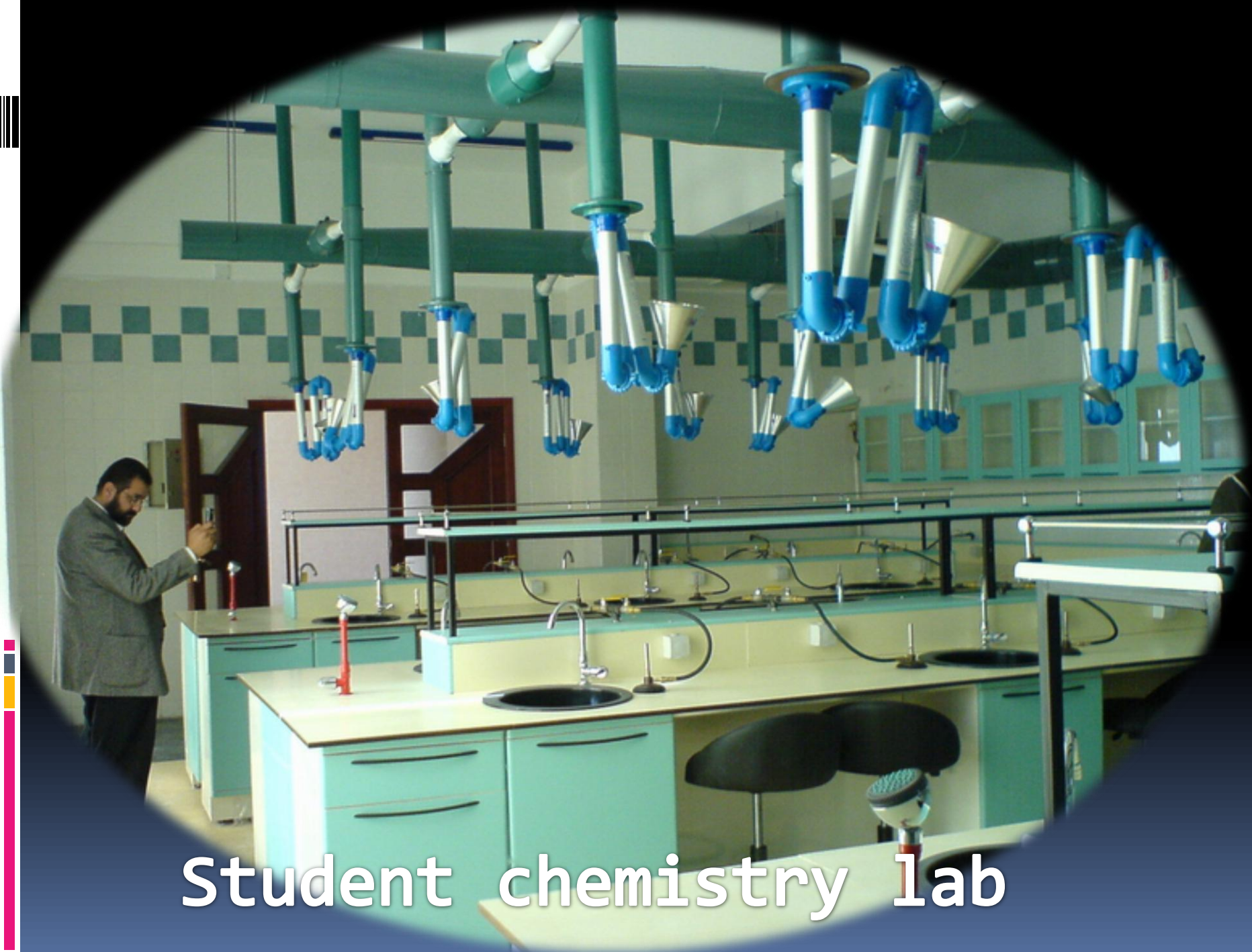

Student chemistry lab



Medical trolley

A man in a blue uniform is seen from behind, standing in front of a large, multi-story pharmacy drawer tower. The tower is composed of numerous drawers, some of which are teal and others are light brown. The man's uniform has a red logo on the back that says "AL-HARMOUK" and features a red map of Iraq. The scene is framed by a circular vignette. On the left side of the image, there are several vertical bars of different colors: black, white, yellow, and pink.

Pharmacy drawer towers



Pharmacy furniture

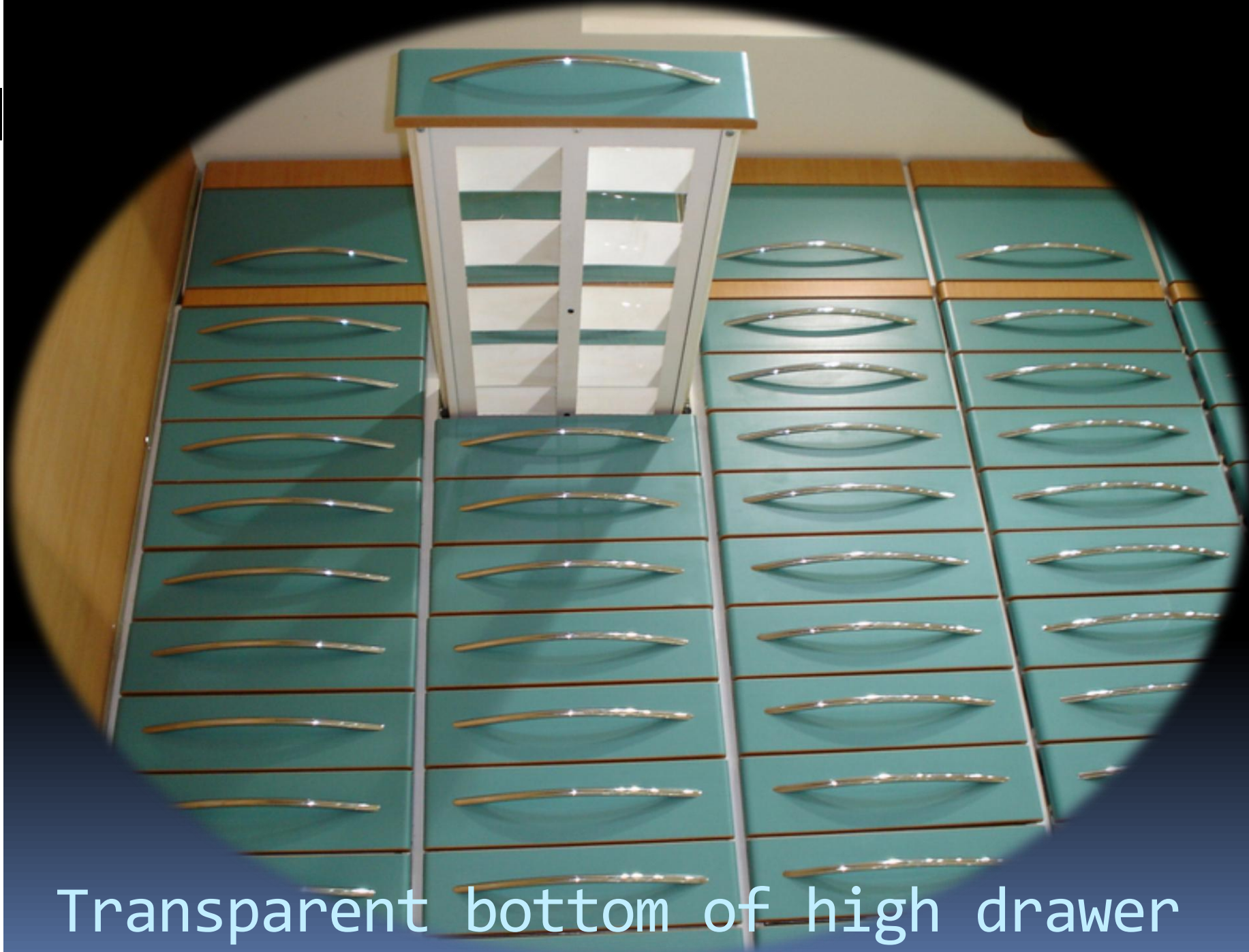

Transparent bottom of high drawer

Drawer inside divisions



DENTAL LABORATORY



غرفة الصب فى معمل أسنان بمستشفى الحرس الوطنى



Drawer with Foot Control



**Flexible 360.
degree**



Glass top



high cylindrical legs .



Various levels cabinets



Glass Top

L Shape



L Shape

Kids or female Clinic





Yarmouk Rounded studio

YARMOUK STUDIO



Lift Up System



**TOUCH
CONTROLLED**

Yarmouk straight Laminate top



with high cylindrical legs .



WITH TOW RAISED SINKS

Majesty of SIRONA® unit with YARMOUK® cabinet



Yarmouk Fish shape



Raw materials

Galvanized steel sheet

- All cabinets made of 1.00 – 1.25 mm thickness Galvanized Steel sheet according to German standard DIN 1541 .
- Galvanized steel has gone through a chemical process to keep it from corroding. The steel gets coated in layers of zinc to avoid rust.



AL-YARMOUK ® pay attention to the details

The pre-treatment & coating process

- ❑ Painting with Epoxy & polyesters electrostatic powder coating. With RAL Color .
- ❑ Easy to clean , resist to common disinfectants substance and chemicals .
- ❑ For galvanized steel surfaces the chromating processes as described in the German standard DIN 50939 have been state of the art for many years. Iron and steel surfaces are still phosphated prior to coating.



AL-YARMOUK ® pay attention to the details

Construction

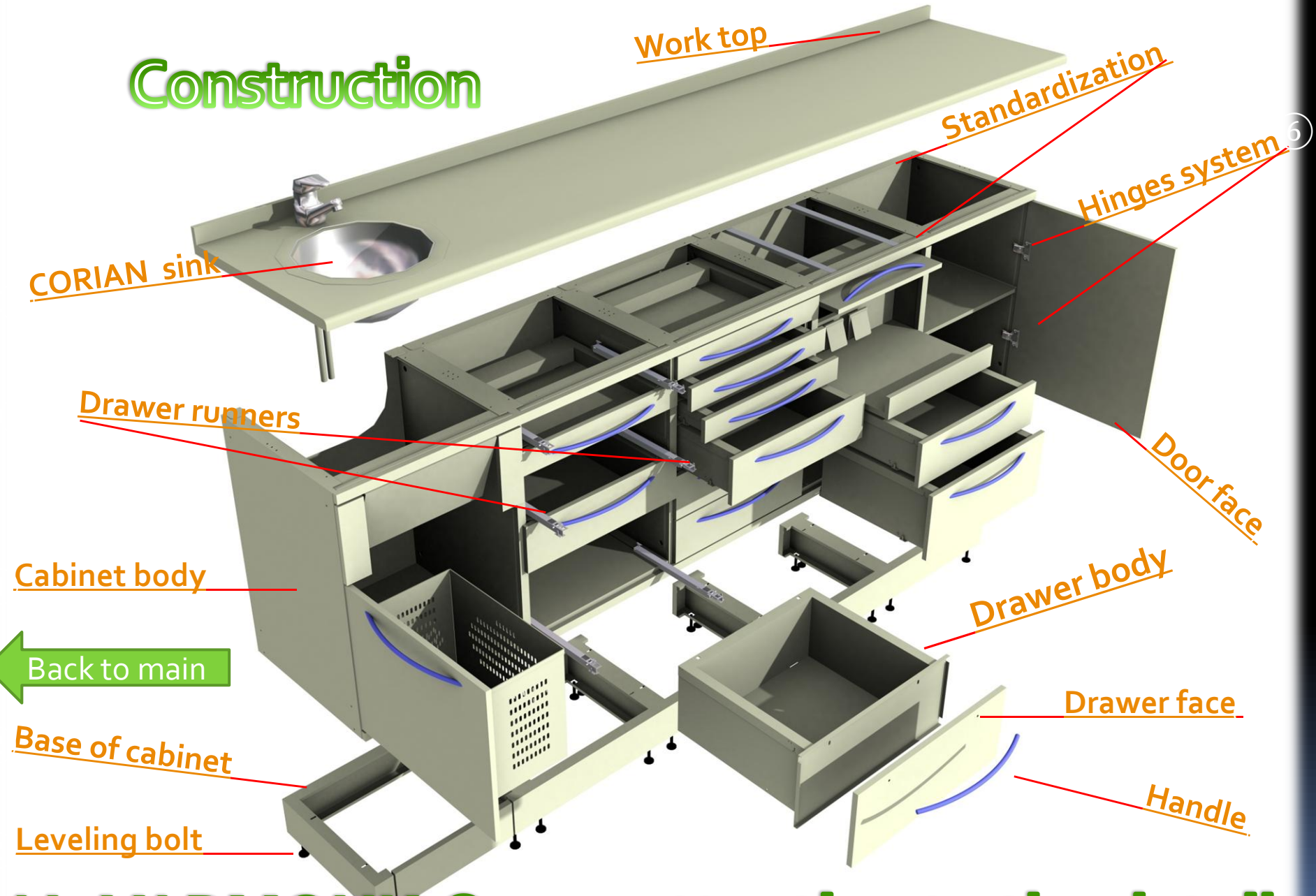

AL-YARMOUK © pay attention to the details

Cabinets bodies

- ❑ Cabinets bodies are self-supporting , designed for acoustic damping and thermal insulation .
- ❑ Made as bent steel sheet structures from one integral part. without welding and without connections or joints. To added durability and to avoid the weaknesses at the joints . In order to be easy cleaning and sterilization and to make sure the arrival of special treatment for the entire paint surface
- ❑ Sides made of double wall steel sheet each at the left and right
- ❑ The bodies are provided with 4 connection holes 2 at the right and 2 at the left lateral walls to screw the cabinets at the place of installation.



AL-YARMOUK ® pay attention to the details

Bases of cabinets

- ❑ The bodies are provided with high plinth made of sheet metal as described above cabinet body description , it is U shape bent from one piece and open at the rear for installation purposes .
- ❑ Otherwise bodies provided with high & low cylindrical legs .
- ❑ Each cabinet has 4 leveling screw which used to easily compensate for uneven or sloping floors .



AL-YARMOUK © pay attention to the details

Drawers Body

- ❑ Body of Drawers are made of steel sheet .
- ❑ Bottom and sides fabricated from bent sheet from one integral part.
- ❑ Drawers front and sides with double wall .



AL-YARMOUK ® pay attention to the details

Doors and drawers faces

- ❑ made from double walls, angular.
- ❑ All drawers are made in zinc-chromate with high-quality Painting with Epoxy electrostatic powder coating
- ❑ Smooth , hygienically perfect, easy to clean surfaces
- ❑ Provided with steel Handles . Length is 20 or 32 Cm. to be easy for using. painted with Epoxy electrostatic with any required color of RAL

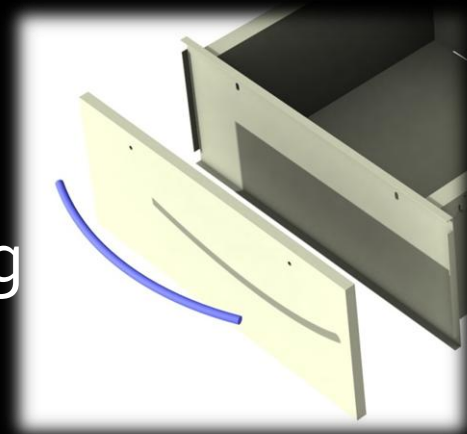

AL-YARMOUK ® pay attention to the details

Standardization

- Effective modular system that combined Flexibility in planning with exceptional functionality and quality to accept changing doors and drawers with different sizes at any time.



AL-YARMOUK ® pay attention to the details

Hinge system

- ❑ Made in Austria
- ❑ Metal hinge, nickel plated
- 110 degree opening angle
- With integrated BLUMOTION
- ❑ free door to cabinet assembly and removal without any screw .
- ❑ The new BLUMOTION closes cabinet door, silently and effortlessly, even when closed with force.
- ❑ BLUMOTION provides perfect motion, bringing comfort to all.
- ❑ The adaptive system adjusts itself to the closing speed and the weight of the door
- ❑ Its integrated overload safety feature due to improper use.



AL-YARMOUK ® pay attention to the details

Drawers runner System

- ❑ Full extension enable optimal storage space
- ❑ Quiet movement and Self –closing
- ❑ Slaw motion (Reduces the forces involved in closing)
- ❑ Durable and robust to support the heaviest load
- ❑ Ease of use and precise alignment

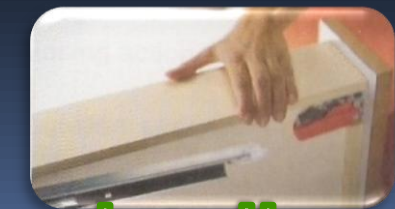

AL-YARMOUK ® pay attention to the details

Where can you find all of these Features ?

AL-YARMOUK® drawer runner system

Made in Austria

TANDEM plus BLUMOTION

Unsurpassed running action using the TANDEM runner principle

Silent and effortless closing action thanks to
BLUMOTION

Can be combined with TIP-ON ,the mechanical opening and SERVO-DRIVE , the electrical opening support systems

As shown below

AL-YARMOUK ® pay attention to the details

Full extension

- ❑ Our full extensions TANDEM plus runner enable optimal storage space utilization and because they improve ergonomic workflows
- ❑ Full extensions offer many advantages
Doctor and his assistance spend a long time in his clinic using Cabinets so it should be a really comfortable place. Therefore, when planning your new clinic make sure that pull-outs and drawers can be fully extended out of the cabinet.
- ❑ Full extensions have the advantage in that they allow you to see and access items all the way at the back in contrast to single extensions. This provides you with a complete view of all items in the pull-out making them easily accessible.
- ❑ that guarantees comfort because of its high functionality.

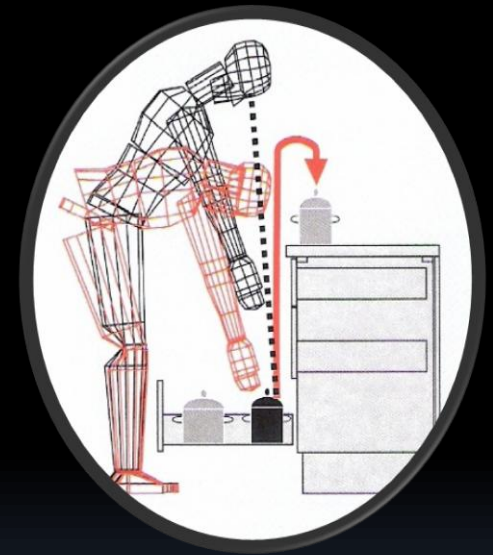

AL-YARMOUK ® pay attention to the details

Quiet movement and Self -closing

- ❑ Low -friction cylindrical nylon roller runners are basis for the unparalleled TANDEM smooth running action for the lifetime
- ❑ Self-closing feature to ensure the drawer completely closing and It is also insure that the drawer will not open when move the cabinet. And it is equipped with safety stop system

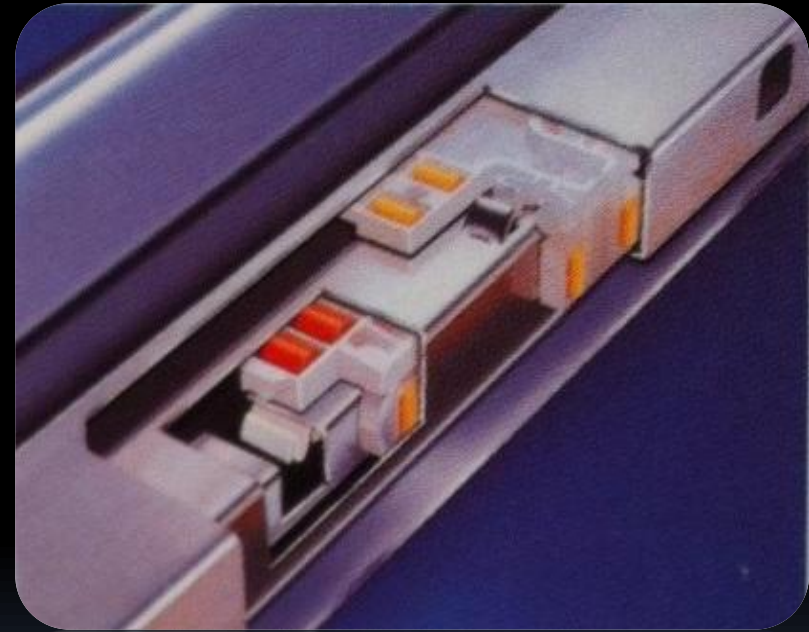

AL-YARMOUK ® pay attention to the details

Slow motion

- ❑ Adaptive system – more than just dampening
- ❑ This next generation of BLUMOTION reduces the forces involved in closing drawers and pull-outs to provide a quiet and easy closing movement .
- ❑ This unique effect is achieved by a diaphragm within the cylinder that reacts to the closing force that is used . Whether the pull-out is heavily laden or empty , pushed gently or with perfect movement every time .



AL-YARMOUK ® pay attention to the details

Ease of use

and precise alignment

Using the TANDEM hook & peg feature, drawer assembly is just a matter of the hand .

This gives you the advantage of fast, simple & accurate fitting.

Tool free height adjustment of up to 2.5 mm . This provides a simple and precise way to adjust the front spacing between drawers front.

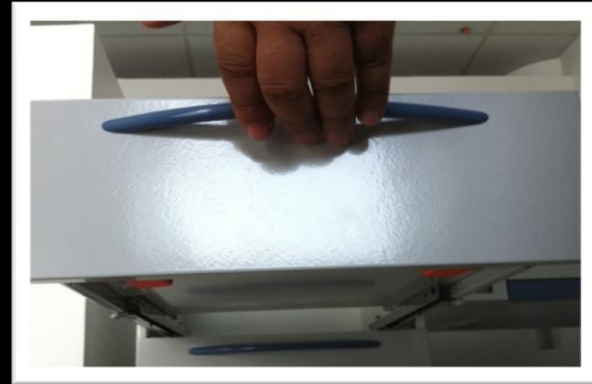

AL-YARMOUK ® pay attention to the details

Durable and robust

- ❑ Strong enough to support the heaviest load. By unique innovation of TANDEM plus .
- ❑ The bridge block design supports the runner system over the entire length of the opening and closing action. It provides a secure and controlled closing action even when fully loaded and it provides a precise gap capability.
- ❑ TANDEM plus . Has an overall load carrying capacity of 30 kg.

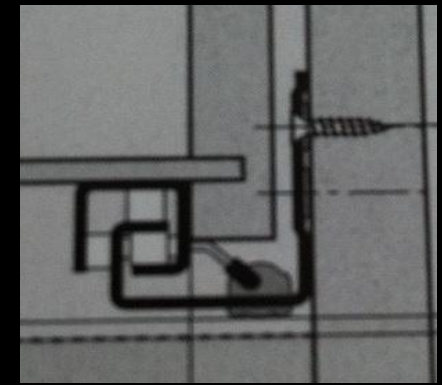

AL-YARMOUK ® pay attention to the details

Work top surfaces

CORIAN® Solid surface



Epoxy resin



Phenolic resin (trespa)



Stainless steel



High pressure laminates



Work top surfaces

- **EPOXY RESIN**

- Use: All types of laboratories & fume cupboards.
- Advantages: resistance to chemical, heat, discolorations & cracking.
- Disadvantages: relatively expensive, welding joints is visible & limited color choice.



- **PHENOLIC RESIN -COMPACT LAMINATE**

- Use: wet rooms, benches with high impact, heavy use applications, industrial & scientific labs.
- Advantages: resistance to moisture, chemicals, impact, fire and heat.
- Disadvantages: relatively expensive, low coating thickness & welding joints is visible



Work top surfaces

- **MELAMINE LAMINATED PLYWOOD**

- Use: laboratory benches, mobile tables, instrument benches.
- Advantages: flat, economical, choice of colors & widely available.
- Disadvantages: not suitable for wet areas, low chemical resistance.



- **STAINLESS STEEL**

- Use: Most type of laboratory workstations, fume cupboards, demonstration areas.
- Advantages: Resistance to moisture, chemical and temperature, easy of cleaning.
- Disadvantages: relatively expensive, sensitive to halogen, high electric conductivity.



- **ACRYLIC RESIN (Solid surfaces)**

- Use: Areas where joint free tops are essential. Clean room workstations.
- Advantages: seamless work tops, large range of colors.
- Disadvantages: low resistance to scratch, medium chemical resistance.



ACRYLIC RESIN work top



- ❑ CORIAN® WORKTOPS .
- ❑ Original CORIAN from DU Pont the benefits of natural stone with the impact resistance and pore-free characteristics of acrylic.
- ❑ chemicals and UV radiation resistant . Heat resistant and environmentally compatible . Easy care properties , long life and easy to repair.
- ❑ 12mm thickness



CORIAN® Sinks

- ❑ **Corian® Seamless Integral Sinks**
- ❑ can be seamlessly joined beneath a countertop in a matching or contrasting colour of Corian®, creating a homogenous design.
- ❑ Non-porous, resistant to stain- and moisture-resistant,
- ❑ sinks in Corian® are hygienic and easy to clean, and will look like new for years to come. If minor cuts or scratches do occur, these are easy to remove.
- ❑ Rounded corners to prevent penetration of dirt or moisture.



AL-YARMOUK® pay attention to the details

Wall cabinets

- ❑ made of sheet metal as described above cabinet body description
- ❑ Sides made of double wall steel sheet each at the left and right
- ❑ Open cabinet or different with hinged steel doors or glazed steel door and glass or safety glass .
- ❑ hanging by BLUM hanging brackets withstand high loads and are exceptionally safe . This kind of reliability is very important for heavily loaded cabinets .
- ❑ wall unit is designed to meet the need to have all disposable hygienic products such as cups , gloves , masks and towels in dedicated , functional cabinet



AL-YARMOUK ® pay attention to the details

Lift Up System for Wall cabinets

- ❑ With AVENTOS HL, the one-piece door front lifts up vertically and provides unhindered access to the interior. This lift system is the ideal solution for an appliance garage or wall cabinet.

The door is easy to open and can be stopped at any desired position. It closes silently and effortlessly thanks to BLUMOTION.



AL-YARMOUK ® pay attention to the details

National industry International quality

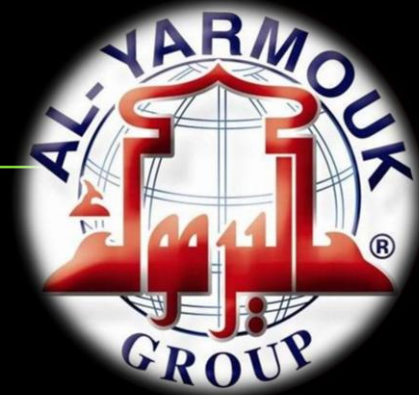

Made in K. S. A,
conforming to international specifications
utilizing certain components, accessories and
options imported from the best
factories in Europe

**AL-YARMOUK® has been granted
ISO 9001 :2008 certificate in the
field of Quality management
system applicable to
manufacturing of Med.& Lab.**

Furniture

AL-YARMOUK® pay attention to the details



M4340909ID

Al-yarmouk K.S.A med-lab furniture



Name of Company	AL-YARMOUK modern factory for Med.& lab. furniture
	Member of AL-YARMOUK group
General manager	AHMAD ABD EL HAMID ABD ELGAWAD
Mobile number	+966 54 217 84 20
Email & web site	Yarmomed@gmail.com www.al-yarmouk.com
Tel. & Fax	(+966) (1) 412 88 11 - 412 88 22
P.O.Box	27617 – Riyadh 11427
Show room	K. S. A. Riyadh Dabab St. Near of Riyadh chamber of commerce
Commercial register	1010241948 DATE 23/ 12/ 1428 Riyadh
Industrial license	101031026262 industrial investment License 1.1 million SR
Main business	Production , installation and maintenance of Medical ,dental and Lab furniture or Casework

Al-yarmouk A.R.E med-lab furniture



Name of Company	AL-YARMOUK modern factory for Med.& lab. furniture
	Member of AL-YARMOUK group
General manager	AHMAD ABD EL HAMID ABD ELGAWAD
Mobile number	+20100 217 84 20
Email & web site	Yarmomed@gmail.com yarmodent@gmail.com
Tel. & Fax	(+20) (2) 33833338- 33821700
P.O.Box	96- haram 12556
Show room	A.R.E. Cairo behind 187 pyramids St.
Commercial register	3184 DATE 1999 Cairo
Main business	Production , installation and maintenance of Medical ,dental and Lab furniture or Casework

صالة العرض: بشارع الضباب بجوار الغرفة التجارية بالرياض



مصنع
اليرموك الحديث
تأثيثات الطبي والمعمل
AL-YARMOUK
Modern Factory
Med Lab Furniture
Tel.: 054 2178420

SHOWROOM : DABABS TREET NEAR THE RIYADH CHAMBER